

Mt. Pleasant Tract

Essex County, VA
Sale Area: 56 +/- Acres (by GPS)

FRM, Inc.
7840 Richmond-Tappahannock Hwy.
Aylett, VA 23009
804.769.3948 Office
804.840.3362 Mobile
804.769.0853 Fax
brian@frmva.com

Consulting Foresters
and
Timberland Appraisers

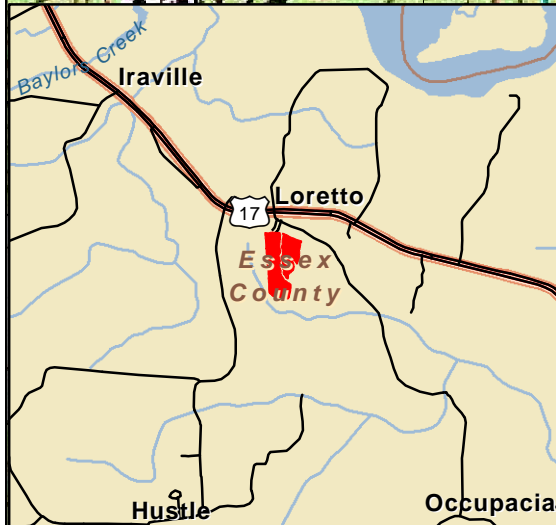
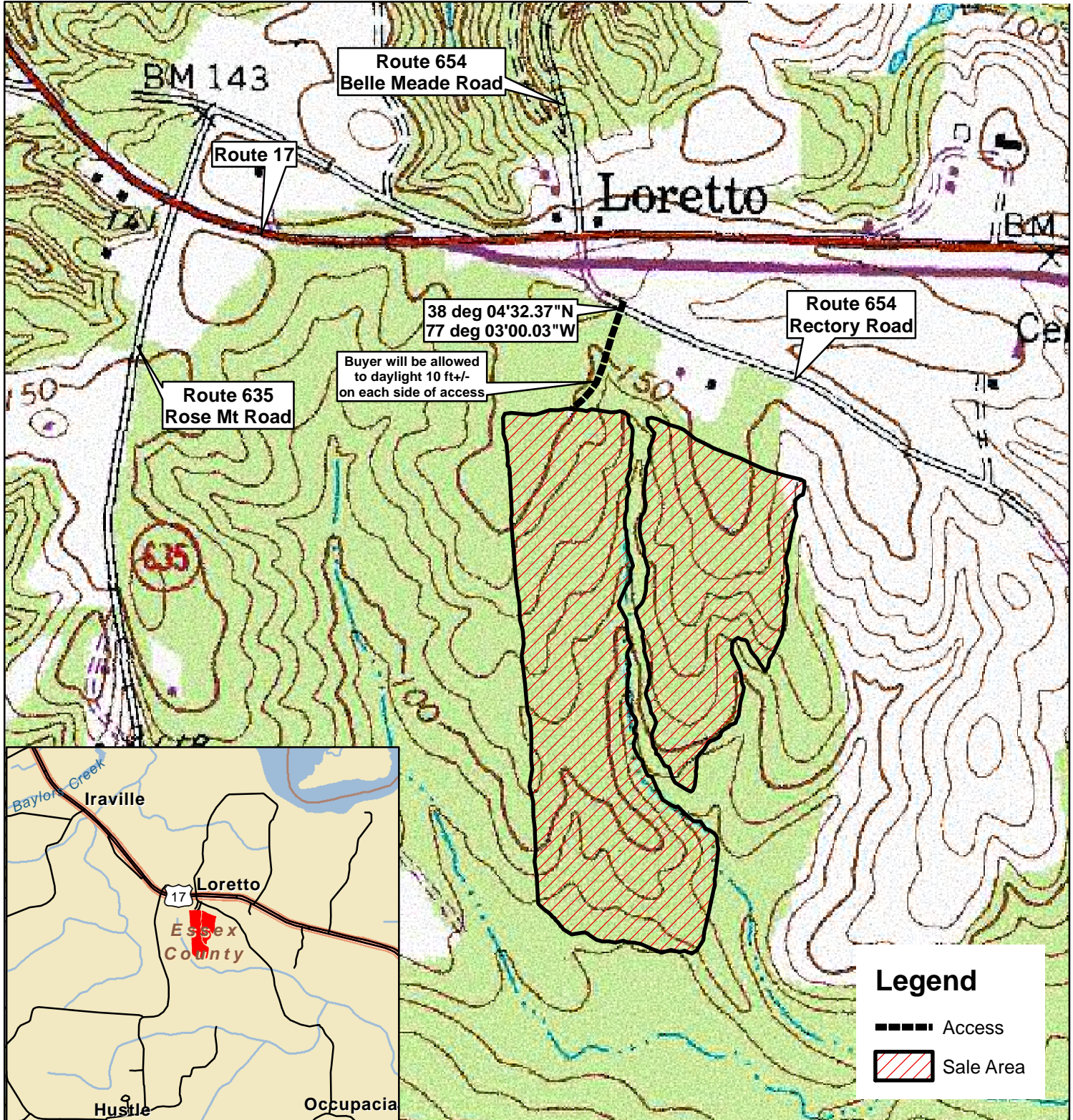

Legend

- Access
- ▨ Sale Area

Harvest Boundaries Marked With Blue Paint
No Harvest From Within SMZ

1 inch = 660 feet

Timber sale at 10 am Thurs., November 29, 2018
At the Forest Resources Mgmt. Office

MBM 10/25/2018